

BARDIA SERIES

FIRSTYLE
HOMES

live your life in style

ASPEN FACADE



style



DESIGNED FOR SIMPLICITY AND
EASE OF LIVING, THE **BARDIA** SERIES
SUITS MODERN BLOCKS WITH
DESIGN AND AFFORDABILITY.

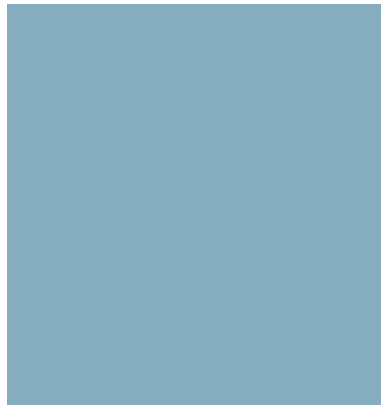
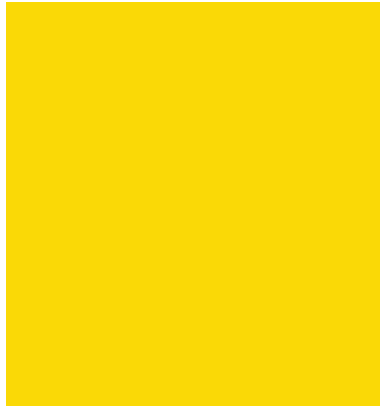

DISCLAIMER: Photographs & Graphic impressions are representative only to finishes available and may not reflect the finish (Display Homes may vary based on design) to the standard design and may also depict fixtures, finishes & features not supplied by Firststyle Homes such as, but not limited to, landscaping & outdoor features, furnishing, decorative items, window furnishing. Dimensions are approximate only and may vary according to façade. Firststyle Homes reserves the right to revise specifications, inclusions, materials and suppliers without notice. Firststyle Homes Pty Ltd ABN 59 087 773 779 B.L. 113412C

BARDIA 16.2

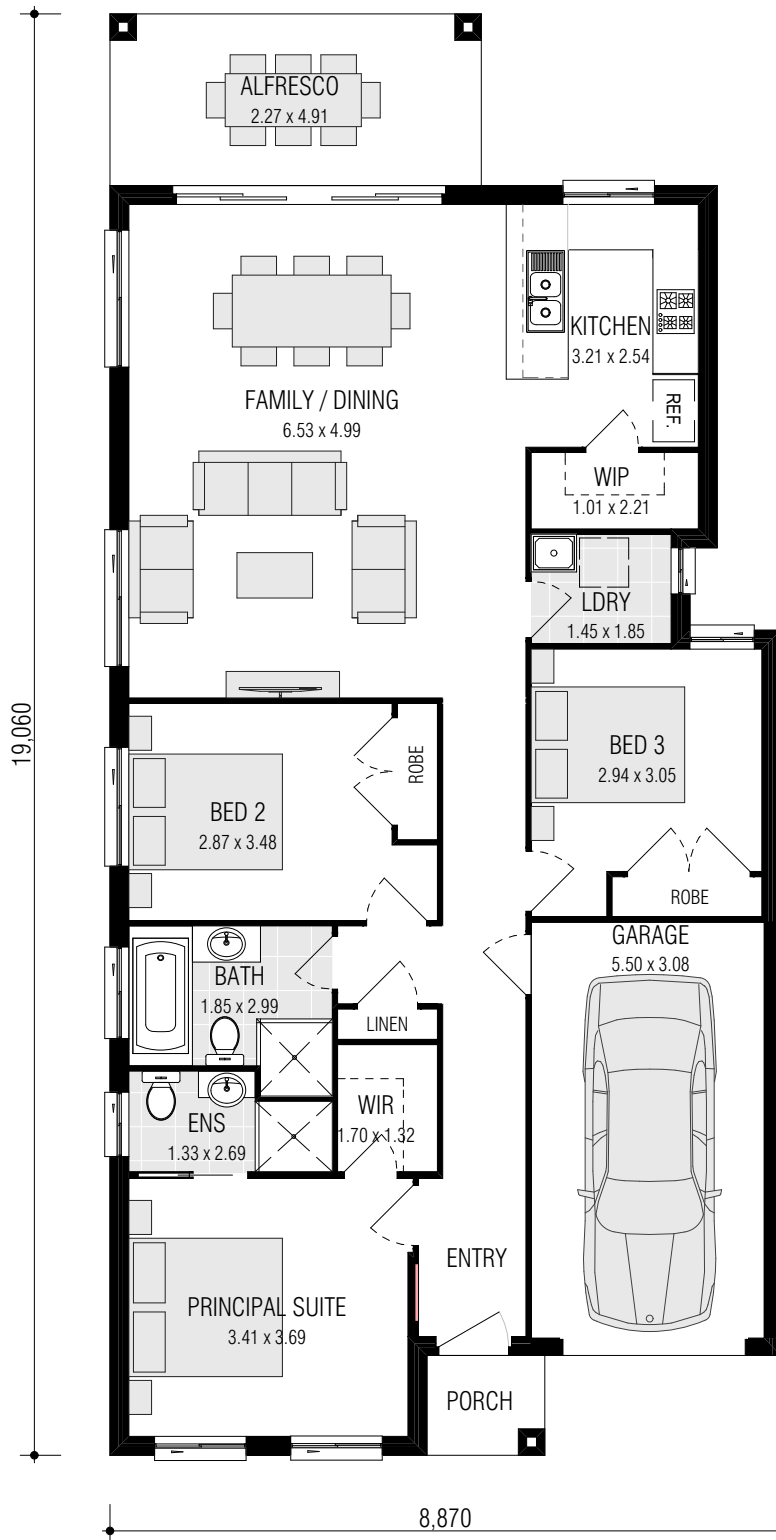

3 2 1

firststyle.com.au

■ FRONTAGE REQUIRED (MINIMUM): 10.71m ■ HOUSE SIZE: 150.63m² ■ SQUARES: 16.2 Sq ■ INCLUDED: ALFRESCO DINING

DISCLAIMER: Photographs & Graphic impressions are representative only to finishes available and may not reflect the finish (Display Homes may vary based on design) to the standard design and may also depict fixtures, finishes & features not supplied by Firststyle Homes such as, but not limited to, landscaping & outdoor features, furnishing, decorative items, window furnishing. Dimensions are approximate only and may vary according to façade. Firststyle Homes reserves the right to revise specifications, inclusions, materials and suppliers without notice. Firststyle Homes Pty Ltd ABN 59 087 773 779 B.L. 113412C

DISPLAY CENTRE LOCATIONS

1. EDMONDSON PARK

VILLAGE SQUARE DISPLAY VILLAGE

9 Clement Road Edmondson Park NSW 2174

PH: 9608 9777 E: edpark@firststyle.com.au

ON DISPLAY: Waterhouse, Chatswood, Keswick & Ashmore

2. LEPPINGTON

HOMEWORLD LEPPINGTON

58 Arkenstone Way Leppington NSW 2179

PH: 9606 4175 E: emeraldhills@firststyle.com.au

ON DISPLAY: Riverside & Aston

3. ORAN PARK

ORAN PARK TOWN

6 Webber Loop Oran Park NSW 2570

PH: 9043 5890 E: oranpark@firststyle.com.au

ON DISPLAY: Fitzroy, Montebello, Burnley Duet & Silkwood

4. SPRING FARM

EVERGREEN SPRING FARM

120 Springs Road Spring Farm NSW 2570

PH: 9138 7753 E: springfarm@firststyle.com.au

ON DISPLAY: Keswick & Nevada

5. MARSDEN PARK

HOMEWORLD MARSDEN PARK

27 Ellison Street Marsden Park NSW 2765

PH: 8630 0429 E: marsdenpark@firststyle.com.au

ON DISPLAY: Norwood & Montara

6. BOX HILL

HOMEWORLD BOX HILL

14 Noah Street, Box Hill NSW 2765

PH: 8630 2020 E: boxhill@firststyle.com.au

ON DISPLAY: Grantham, Avoca & Clovelly



1300 FIRSTSTYLE
3 4 7 7 8 9 5 3
firststyle.com.au

DISCLAIMER: Photographs & Graphic impressions are representative only to finishes available and may not reflect the finish (Display Homes may vary based on design) to the standard design and may also depict fixtures, finishes & features not supplied by Firststyle Homes such as, but not limited to, landscaping & outdoor features, furnishing, decorative items, window furnishing. Dimensions are approximate only and may vary according to façade. Firststyle Homes reserves the right to revise specifications, inclusions, materials and suppliers without notice. Firststyle Homes Pty Ltd ABN 59 087 773 779 B.L. 113412C